

SPORTSLINK

Furry Park, Cloghran, Santry, Dublin 9.
Ph. 01 8621200 Fax 01 8621162
www.sportslink.ie email: membership@sportslink.ie

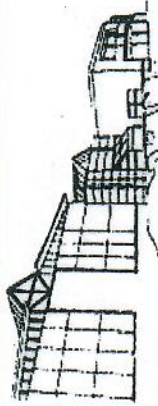

Full Membership Application Form

Primary member details:

Surname:
Forename:
Date of Birth: Male/Female:
Home Address:
Home phone number:
Mobile Number:
Email Address:
Department/Company Name:
Department/Company Address:

Family details:

Spouse/Partner details:
Surname: Forename:
Date of Birth: Male/Female:
Children's details:
Name: Date of Birth: Male/Female:
Name: Date of Birth: Male/Female:
Name: Date of Birth: Male/Female:
Name: Date of Birth: Male/Female:
Proposed by: Membership No:
Seconded by: Membership No:

Details of Membership

Full Membership is applicable to persons who are employed by the Civil Service, Public Service or Eircom.

Packages Available	Full Membership	Full Single Swim & Gym Package	Full Family Swim & Gym Package
Membership Fee	€156 Annual Fee	€610 Annual Fee	€730 Annual Fee
Details	Facility usage is charged in addition to membership fee.	This package includes usage of the pool, adventure area and gym facilities for both you and your family.	This package includes usage of the pool, adventure area and gym facilities for both you and your family.
Please indicate which package you require by entering Y in the appropriate column	Y	Y	Y
Payment Methods	1. Deduction at source* 2. Direct Debit** 3. Cash, Cheque, or Credit Card	1. Cash, Cheque or Credit Card 2. Direct Debit**	1. Cash, Cheque or Credit Card 2. Direct Debit**

*Deductions at source is when your yearly membership subscription is deducted directly from your salary on a weekly/fortnightly/monthly basis. This facility is not available for the following organisations: The Army, Teachers (primary & secondary), An Post, Mater Private Hospital, Bord Gais, Dublin Bus, National Lottery and ESB. Persons who fall into these categories can pay using Options 2 & 3.

** If you opt for the direct debit payment option, your fees are paid to Sportslink on a quarterly basis i.e. every 3 months. The first quarter of which must be paid by cash, cheque or credit card.

Payment Option 1 - Deduction at Source

Authorisation to the Accountant,
Department/Company:
Department/Company Address:

Please deduct from my salary the sum of €3.00 weekly €6.00 fortnightly €13.00 monthly
The rate of subscriptions may be increased or decreased by you in accordance with any revision of the rates notified to me by the secretary and promulgated in accordance with the rules of the company in the normal way. I recognise that the deductions are being made as a convenience to me and may be terminated at any time. The ultimate responsibility that they have been made rests with me and not with the State or Company.

Signed:
Full Name:
Official Address:
Grade: Pay Group: Personnel/Payroll No:

Payment Option 2 - Cash, Cheque & or Credit Card.

Payments for yearly membership can be made direct to Sportslink using cash, cheque or credit card.
Completed applications and appropriate membership fees should be returned to Membership Administration, Sportslink, Furry Park, Santry, Dublin 9.

Applications will primarily be accepted by Membership Personnel. Please note that all applications are subject to ratification by Sportslink's Management Board of Directors, where they can at any stage reject an application.
Use of the facilities in Sportslink is permitted upon receipt of payment and membership cards will be forwarded in due course. All applications must be Proposed and Seconded by two full members to meet the club constitution.

Payment Option 3 - Direct Debit

Please complete the SEPA/DD mandate available at reception. Please note that direct debit instruction is continuous. Membership fees will roll over automatically and shall continue to be debited from your account until such time as you (the member) cancel the instruction in writing with Sportslink membership office.

Family Membership

Family Membership at Sportslink is defined as follows:
Parent or parents (2) and children (under the age of 18) residing at the same address. Sportslink reserves the right to request proof of address. Children over 18 and in full time education are entitled to join as part of a family membership, provided they issue Sportslink with proof i.e. valid student ID and they are under 23 years of age.

Where did you hear about us?
 Newsletter
 News/local paper
 Internet/Web
 Word of mouth
 Other (please specify) _____

Declaration

I agree to abide by the memorandum and articles of the companies

Signed Date